



Royal Series Underbar Modular Bar Die System

Model: _____ Item #: _____ Date: _____

Project: _____ Qty: _____ Approved By: _____



Standard Features

- Bar die structure fabricated out of 16 gauge galvanized steel with stainless steel bartender finish
- Supports 1,000 pounds per foot of downward force
- No legs required. Units attached to bar die structure for quick and easy cleaning
- Chaseways built into structure to conceal all soda, beer, electrical and plumbing lines. Makes for a cleaner, more appealing bar
- Built-in electrical outlets installed per customer's request (quantity and location to be verified)
- Units pre-assembled at factory and shipped in sections up to 8'-0" in length for easy installation (cuts installation costs)
- Bar die structure can easily be installed and sealed to floor to prevent seepage from bartender side to customer side
- Bar top and front panels (by millwork) can be easily installed to structure
- Front panels (by millwork) easily removed for access to soda, beer, electrical and plumbing lines for future service or repair

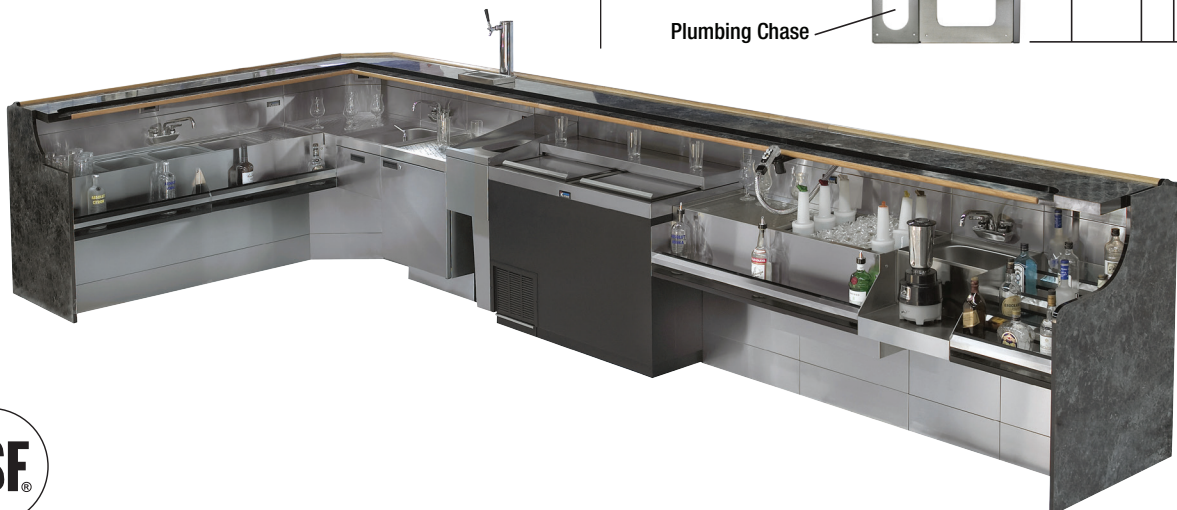
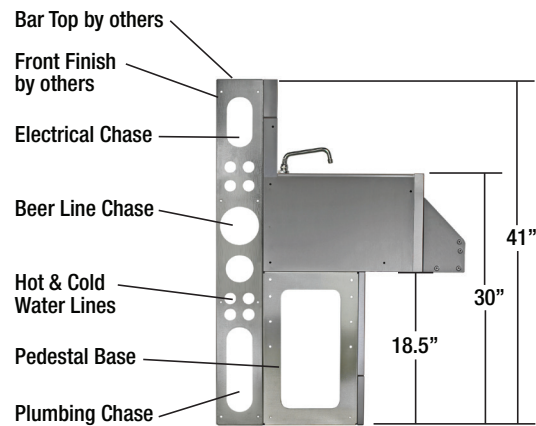



Royal Series Underbar Modular Bar Die System

Model: _____ Item #: _____ Date: _____

Project: _____ Qty: _____ Approved By: _____

Typical Ice Bin with Built-In Cold Plate

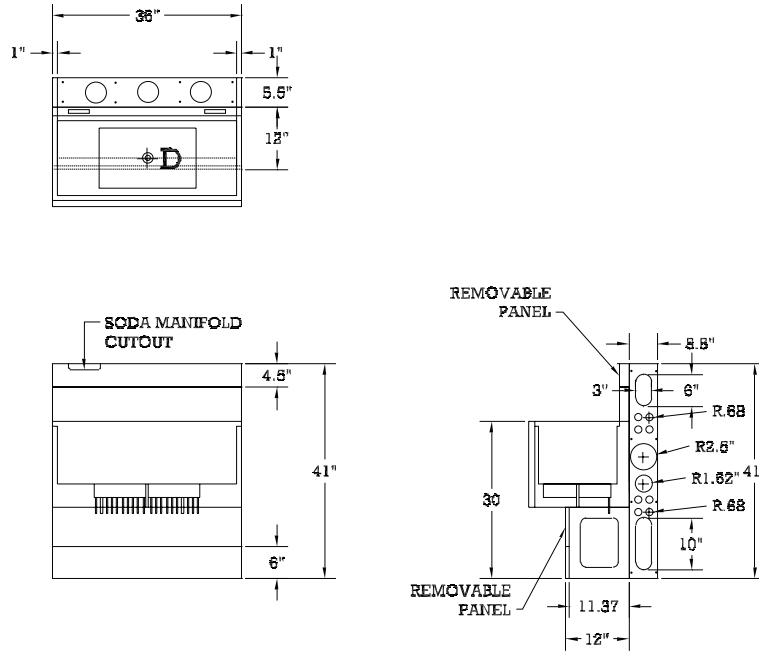

Cabinet Side View

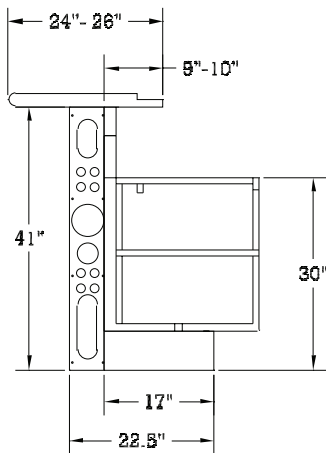

Bar Sink Side View

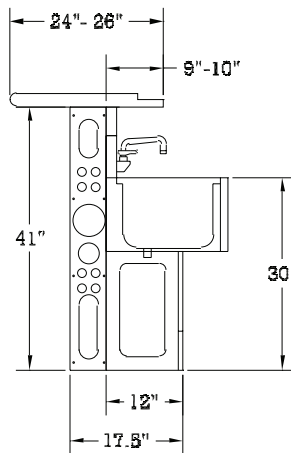

Flat Wall Side View

