



ROYAL SERIES UNDERBAR LIQUOR DISPLAYS

MODEL: _____ PROJECT: _____ ITEM #: _____ QTY: _____

PRODUCT IMAGE



KR18-24RD SHOWN

AVAILABLE IN 1800 or 2100 SERIES

OPTIONAL ACCESSORIES

- **LC** Locking Cover (Add "LC" to end of Model number)
- **KR-310** Right End Splash
- **KR-311** Left End Splash

STANDARD FEATURES

- **Bottle Steps**
20 gauge stainless steel
- **Guardrails**
20 gauge stainless steel
- **Sides**
18 gauge stainless steel
- **Backsplash**
20 gauge stainless steel
- **Back and Bottom**
20 gauge galvanized steel
- **Legs**
1 5/8" tubular 16 gauge stainless steel with grey plastic bullet foot



CERTIFICATIONS:

APPROVED BY:

Due to our commitment to continued product improvement, specifications are subject to change without notice.

Printed in the USA

Krowne Metal Corporation

100 Haul Rd. Wayne, NJ 07470 • Toll Free: (800) 631-0442 • Fax: (973) 872-1129
sales@krowne.com • www.krowne.com • www.facebook.com/KrowneMetal • www.twitter.com/KrowneMetal

Rev. 08/2015
No. 5.21



ROYAL SERIES UNDERBAR

LIQUOR DISPLAYS

MODEL: _____ PROJECT: _____ ITEM #: _____ QTY: _____

1800 SERIES

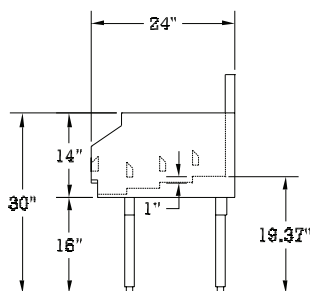
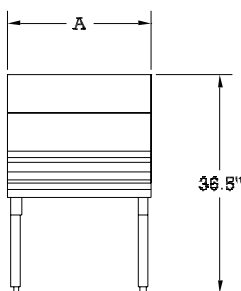
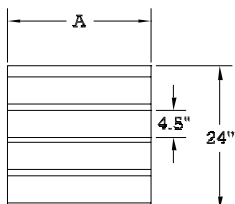

Model Numbers	Overall Length (A)	Bottles Stored	Weight (lbs.)
KR18-12RD	1'-0"	12	30
KR18-18RD	1'-6"	20	35
KR18-24RD	2'-0"	28	40

2100 SERIES

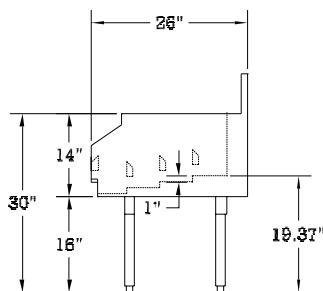
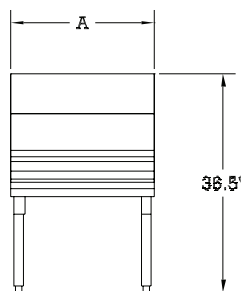
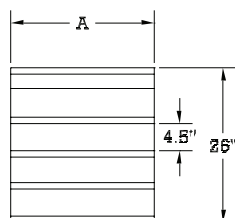

Model Numbers	Overall Length (A)	Bottles Stored	Weight (lbs.)
KR21-12RD	1'-0"	12	30
KR21-18RD	1'-6"	20	35
KR21-24RD	2'-0"	28	40



APPROVED BY:

CERTIFICATIONS:

Due to our commitment to continued product improvement, specifications are subject to change without notice.

Printed in the USA

Krowne Metal Corporation

100 Haul Rd. Wayne, NJ 07470 • Toll Free: (800) 631-0442 • Fax: (973) 872-1129

sales@krowne.com • www.krowne.com • www.facebook.com/KrowneMetal • www.twitter.com/KrowneMetal

Rev. 08/2015
No. 5.21