



# Electrolux

## EMPower Open Cupboard Base - 36"

ITEM #

MODEL #

NAME #

SIS #

AIA #



Electrolux

EMPower  
Open Cupboard Base - 36"



EMPower

Open Cupboard Base - 36"

169031 (AV36)

EMPower Open Cupboard  
Base, 36" wide

### Short Form Specification

#### Item No.

EMPower unit to be Electrolux Open Cupboard 36" (915 mm). EMPower unit to be installed below Electrolux top EMPower units. Construction in Stainless Steel. Right-angled side edges to allow flush fitting between EMPower units. Supplied with 6" (150 mm) height adjustable, removable legs. EMPower unit may be installed on castors.

### Main Features

- Unit to be installed below Electrolux top models.
- Right-angled side edges to allow flush fitting joints between units, eliminating gaps and possible dirt traps.
- Supplied with 6" (150 mm) height adjustable, removable legs.
- Unit may be installed on casters.
- Base compartment for storage of pots, pans, sheet pans, etc.
- Included Accessories: 4 pins for connection to top units.
- Height adjustable feet.

### Construction

- Constructed in Stainless steel with Scotch Brite finish to meet the highest hygiene standards.
- 4 screws to install top unit on the cupboard base are supplied with the top units.

### Optional Accessories

- Kit connecting bases - 2 plates and 2 wheels PNC 169041 ☐
- EMPower kit of 2 side supports for shelf grids for 24" and 36" open cupboard bases PNC 169089 ☐
- EMPower shelf grid for 36" open cupboard base PNC 169092 ☐
- Portioning Shelf 12" PNC 169173 ☐
- Portioning Shelf 16" PNC 169174 ☐
- Portioning Shelf 24" PNC 169175 ☐
- Portioning Shelf 36" PNC 169176 ☐
- Kit 4 wheels - 2 swivelling with brake - it is mandatory to install base support and wheels PNC 206135 ☐



APPROVAL:

Electrolux Professional, Inc.

[www.electroluxusa.com/professional](http://www.electroluxusa.com/professional)

10200 David Taylor Drive, Charlotte, NC 28262 • Telephone Number: 866-449-4200 • Fax Number: 704-547-7401



# Electrolux

## EMPower Open Cupboard Base - 36"

Front

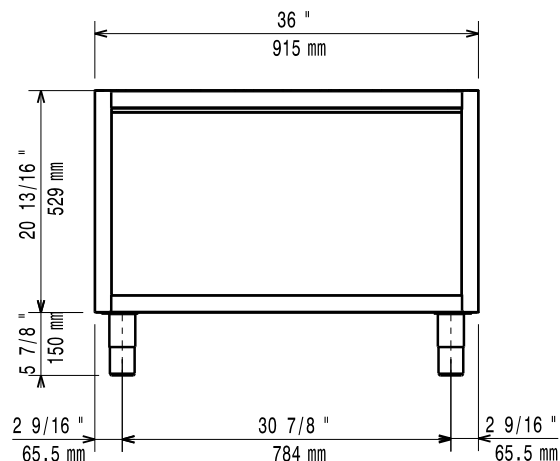

Top

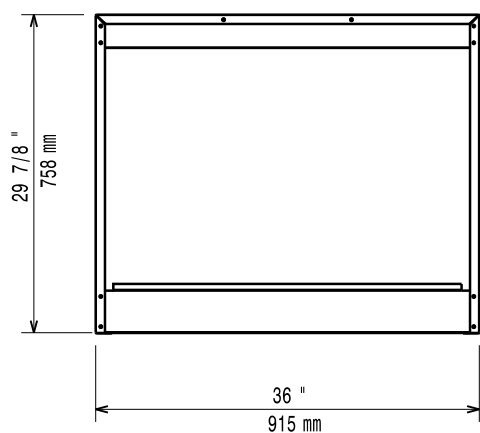

Side

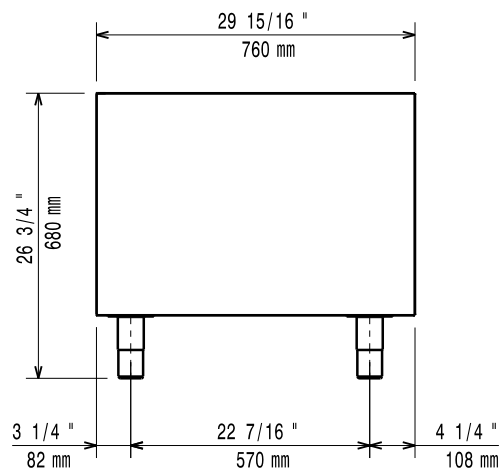

### Key Information:

#### External dimensions, Width:

169031 (AV36) 36 1/32" (915 mm)

External dimensions, Depth: 29 15/16" (760 mm)

External dimensions, Height: 26 11/16" (678 mm)

Net weight: 66 lbs (30 kg)

Shipping width: 38" (965 mm)

Shipping depth: 35 7/16" (900 mm)

Shipping height: 35 13/16" (910 mm)

Shipping weight: 79 lbs (36 kg)

Shipping volume: 27.91 ft<sup>3</sup> (0.79 m<sup>3</sup>)