

ITEM	PART NO.	DESCRIPTION	QTY.	WEIGHT	NOTE NO.
1	MTC30650x	1550 RM Weldment	3	-	
2	MT38440	3/4" X 40" GALV THREADED ROD GRADE B7	6	4.98 LBS	
3	GWL-06	3/4" GALV LOCK WASHER	12	0.04 LBS	
4	GN-06	3/4" GALV HEX NUT	12	0.12 LBS	
5	DCP10	SMALL CLAMP HALF	6	2.21 LBS	
6	MTC323704	Clamp Bar	6	2.37 LBS	
7	RK01	KICKER STANDOFF WELDMENT	3	12.71 LBS	
8	RK02	CONNECTION BRACKET	6	1.21 LBS	
9	RKxx	KICKER ARM SUPPORT TUBE , 36"	3	-	
10	GB-0546A	5/8" X 4-3/4" GALV BOLT KIT A325	6	0.50 LBS	
11	GB-0520A	5/8" X 2" GALV BOLT KIT (A325)	12	0.27 LBS	
12	MT-381-8	5/8" X 8" GALV THREADED ROD	6	0.69 LBS	
13	GWF-05	5/8" GALV FLAT WASHER	12	0.06 LBS	
14	GWL-05	5/8" GALV LOCK WASHER	12	0.03 LBS	
15	GN-05	5/8" GALV HEX NUT	12	0.08 LBS	

REVISIONS				
REV.	ECN	DESCRIPTION	BY	DATE
A	8000005392	INITIAL RELEASE	MSM	09/22/14

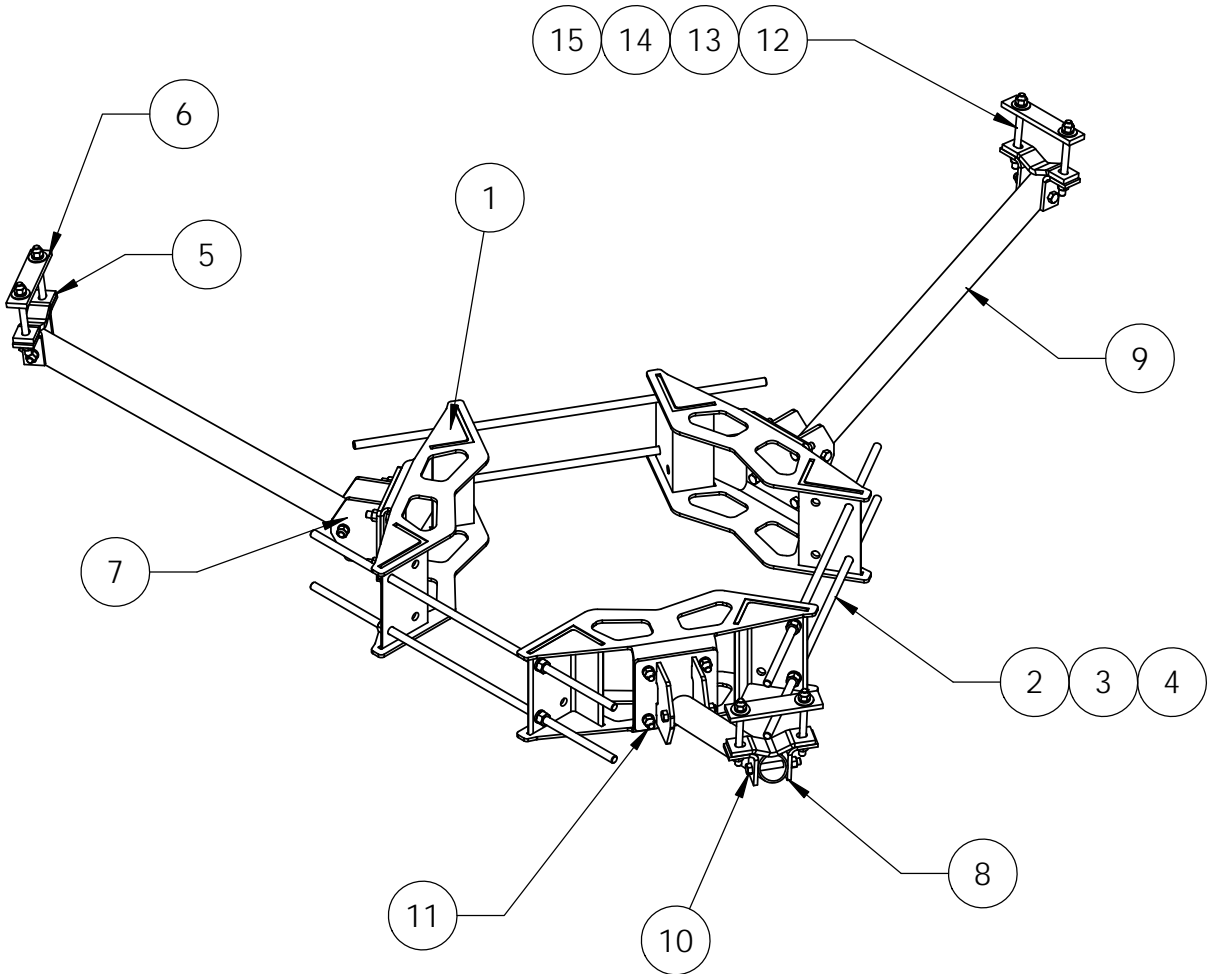

RK-3LM SERIES TABLE

ASSEMBLY	DESCRIPTION	RK36	RK60	MTC306504	MTC306505	WEIGHT
RK-36-3L	REINFORCEMENT KIT, 30"-60 "MP, 36" ARM, 3-SECTOR	3	-	-	3	340.95 LBS
RK-60-3L	REINFORCEMENT KIT, 30"-60 "MP, 60" ARM, 3-SECTOR	-	3	-	3	370.15 LBS
RK-36-3M	REINFORCEMENT KIT, 15"-50 "MP, 36" ARM, 3-SECTOR	3	-	3	-	315.07 LBS
RK-60-3M	REINFORCEMENT KIT, 15"-50 "MP, 60" ARM, 3-SECTOR	-	3	3	-	347.27 LBS

- NOTES:
- 1. ALL METRIC DIMENSIONS ARE IN BRACKETS.
  - 2. SEE SHEET 2 FOR MONOPOLE RANGES AND ARM LENGTHS.

<div>These drawings and specifications are the proprietary property of CommScope Inc. and may be used only for the specific purpose authorized in writing by CommScope Inc.</div> <div>ALL DIMENSIONS ARE IN INCHES U.O.S. TOLERANCES UNLESS OTHERWISE SPECIFIED: .X = ± .12      ANGLES    ±2° .XX = ± .06      FRACTIONS    ±1/32 .XXX= ± .03</div> <div>REMOVE BURRS AND BREAK EDGES .005</div> <div>DO NOT SCALE THIS PRINT</div>	DRAWN BY: MSM	SHEET: 1 of 2	PART NUMBER: RK-3LM SERIES
	CHECKED BY: TP	SCALE: NTS	DESCRIPTION: REINFORCEMENT KIT, 3-SECTOR SERIES
	DATE: 09/22/14	MATERIAL: A36, A529, A500	DRAWING TYPE: SHOP DRAWING
	REVISION: A	FINISH: GALV A123	<div>COMMScope®</div> <div>Hickory, NC 28602      U.S.A.</div>
		WEIGHT: SEE TABLE	

