

RSRF SERIES CORD GRIP DIMENSIONS

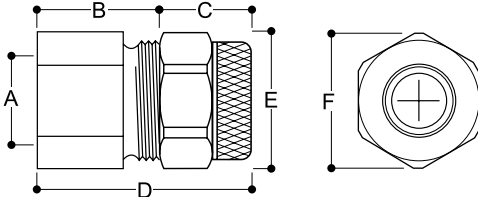

SPECIFICATIONS						
Conduit Size	A Body Bore	B	C	D	E Body Hex	F Nut
3/8"	0.44	0.62	0.75	1.38	0.88	0.99
1/2"	0.62	0.69	1.06	1.75	1.12	1.33
3/4"	0.63	0.81	1.00	1.81	1.31	1.33
1"	0.94	0.94	1.31	2.25	1.63	1.70
1 1/4"	1.44	1.06	1.69	2.75	2.25	2.55
1 1/2"	1.44	1.06	1.69	2.75	2.25	2.55
2"	1.88	1.25	2.38	3.63	2.75	3.25

NOTE: Dimensions for the RSRH Hub Style Cord Grips are the same as above except for the addition of the nipple.